

Congratulations on your purchase.
Your ASCEND INSTANT LIGHTED 6P TENT is very easy to pitch.
Follow these instructions to pitch your tent quickly, safely, and easily.
We strongly advise you to assemble your new tent once before going camping to become familiar.

1. Assemble the tent

A. Remove all contents from the carry bag.

B. Unfold the (4) leg poles outwardly to set the tent flat.

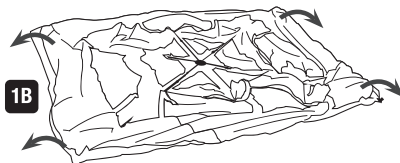

C. Pull roof poles up to allow the joints to move outwardly.

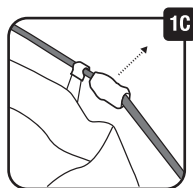
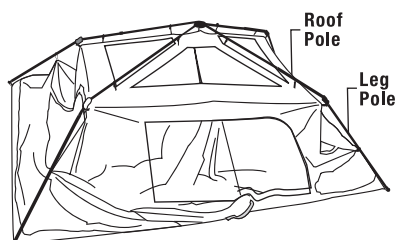

D. Extend all (4) leg poles until the locking buttons “click”.

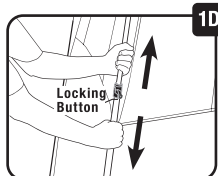

2. Attach the rainfly

A. Lay out rainfly, spread it and make sure the logos are facing up.

B. Find a small “FRONT” label sewn on one side of the rainfly’s underside. Note this label is attached on the underside of the rainfly, therefore, it is not visible.

C. Place the rainfly over the top of the tent body making sure the FRONT label is over the door.

D. Snap (4) clips on the ends of straps to each leg pole.

E. Insert fiberglass pole in the sleeve on the underside of rainfly above the door.

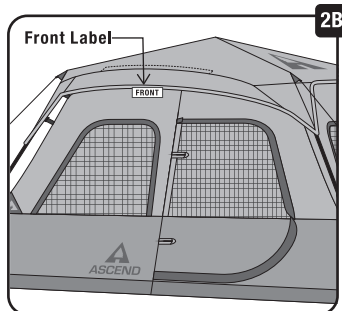

2. Attach the rainfly (cont.)

F. Insert pole ends into the holes of the pole clips on both sides of the door.

G. There are hook-and-loop straps (4) on the underside of the rainfly. Attach them to each pole.

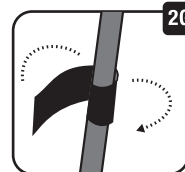
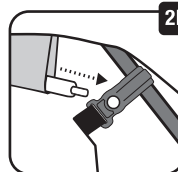

3. Stake the tent

A. Insert stakes through webbing loops of each leg pole to ground the tent. Make sure you are driving stakes at roughly a 45° angle away from the tent.

B. Stake out guy lines from the rainfly at roughly a 45° angle away from the tent using the plastic sliders to adjust the tension.

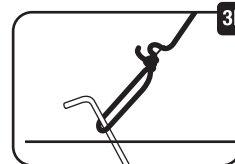
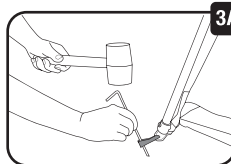

C. Stake out ground vent on the back of the tent.

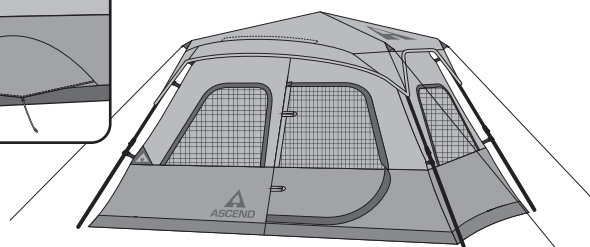
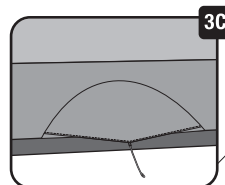

ASSEMBLY INSTRUCTIONS

#4447039 INSTANT LIGHTED TENT 6P

4. Add the accessories

A. LIGHTS – Slide battery pack (included) inside pouch located inside the tent. This battery pack takes 4 D batteries (not included). Insert batteries aligning the terminals correctly as per illustration and secure the cover.

Note: You can also use a portable power source with USB-A port (not included).

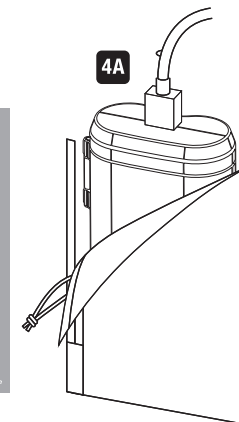

5. Things you should know

- Under certain conditions (cold weather, high humidity, etc.) condensation will form on the inside surfaces of your tent. Condensation is caused by water vapor from your breath, perspiration, or any wet clothing inside your tent. It's NOT LEAKAGE through the tent fabric. It can be minimized by removing wet clothing from your tent and by providing good ventilation through the tent.
- Never store tent, even for a short period of time, without drying it thoroughly and brushing off caked dirt. Do not pack stakes or poles inside your tent. Use a separate storage bag.
- Stakes should be removed by pulling on the stake itself. Never pull on the tent fabric or tent stake loop to remove stake.
- Tent poles should not be left telescoped together during storage.
- Seam sealer has not been provided with your tent. For additional protection we recommend seam sealing your tent prior to camping. Seam sealer may be purchased at your Bass Pro Shops or online.
- Do not leave your tent set up for weeks at a time, be aware that exposure to the ultraviolet rays of the sun can seriously damage material and/or cause it to become discolored.
- Take down your tent in the reverse order and keep fold the same length as the tent bag.

Warning: Keep all flame and heat sources away from this tent fabric. This tent meets the flammability requirements of CPAI-84. The fabric will burn if left in continuous contact with any flame source. The application of any foreign substance to the tent fabric may render the flame-resistant properties ineffective.

CAN ICES-005 (B) / NMB-005 (B)