

TRACKER LITHIUM

TLi/WR100-DP Gen2



ELECTRICAL SPECIFICATIONS

Nominal Voltage	12.8V
Nominal Capacity	100Ah
Capacity @ 25A	240 min
Resistance	≤30 mΩ @ 50% SOC
Efficiency	99%
Self Discharge	<3% per Month
Maximum Modules in Series	4

DISCHARGE SPECIFICATIONS

Maximum Continuous Discharge Current	100A
Peak Discharge Current	800A (10s)
BMS Discharge Current Cut-Off	1000A ± 100 A (2 ± 1 ms)
Recommended Low Voltage Disconnect	10V
BMS Discharge Voltage Cut-Off	9.2V (2.3 ± 0.1 vpc) (2 ± 0.5s)
Reconnect Voltage	10V (2.5 ± 0.1 vpc) (2 ± 0.5s)
Short Circuit Protection	200-800 μA

TEMPERATURE SPECIFICATIONS

Discharge Temperature	-4 to 140 °F (-20 to 60 °C)
Charge Temperature	-4 to 113 °F (-20 to 45 °C)
Storage Temperature	23 to 95 °F (-5 to 35 °C)
BMS High Temperature Cut-Off	167 °F (75 °C)
Reconnect Temperature	122 °F (50 °C)

MECHANICAL SPECIFICATIONS

Dimensions (L x W x H)	13.04 X 6.78 X 8.50" 331 X 172 X 216 MM
Weight	32.6 lbs (14.8 kg)
Terminal Type	M8 x 1.25 x 2mm
Terminal Torque	80 - 100 in-lbs (9 - 11 N-m)
Case Material	ABS
Enclosure Protection	IP67
Cell Type - Chemistry	Cylindrical - LiFePO4

CHARGE SPECIFICATIONS

Recommended Charge Current	20A
Maximum Charge Current	100A
Charge Current 14 to 32 °F (-10 to 0 °C)	≤0.3 C
Charge Current -4 to 14 °F (-20 to -10 °C)	≤0.02 C
Recommended Charge Voltage	14.2 V - 14.6 V
BMS Charge Voltage Cut-Off	15.4V (3.85 ± 0.05 vpc) (1.5 ± 1.0 s)
Reconnect Voltage	14.4V (3.65 ± 0.05 vpc)
Balancing Voltage	14.2V (3.6 ± 0.05 vpc)

COMPLIANCE SPECIFICATIONS

Certifications	UN 38.3 & CE (BATTERY) UL1642 (CELLS) (FILE# MH64443) IEC62133 (CELLS)
Shipping Classification	UN 3480, CLASS 9

DIMENSIONAL SPECIFICATIONS

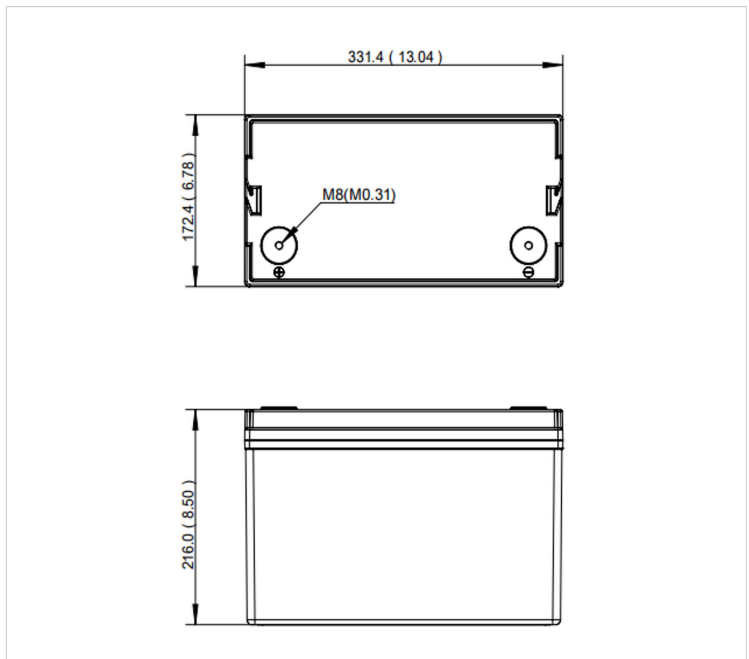

PERFORMANCE CHARACTERISTICS

