



Breakwater

BR7000, BR8000

Breakwater Spinning Reel

Congratulations on your purchase of an Offshore Angler™ Breakwater reel! These reels are manufactured with the highest-quality components and have been extensively tested in a multitude of conditions. Each reel is jam-packed with performance-enhancing components and features to make your day on the water more productive and enjoyable.

These include: double-shielded stainless steel ball bearings to keep the moving parts running smoothly, a stainless steel main shaft to provide support, a 10-washer drag system to dissipate heat and provide smooth drag performance, Powerlock™ instant anti-reverse to ensure positive hooksets, a chrome-plated line roller that manages line twist, a solid machined-aluminum handle for positive cranking power, and a forged-aluminum spool that has been anodized to protect against corrosion.

Reel Specifications

Model	Bearings	Weight (oz.)	Max Drag (lbs.)	Line Capacity Mono/Braid (lbs./yds.)	IPT*	Gear Ratio
BR7000	8 (7+1)	22	33	20/320, 25/240, 30/210 30/680, 40/590, 50/410	39	4.6:1
BR8000	8 (7+1)	22	33	25/280, 30/240, 40/160 40/685, 50/475, 65/370	41	4.6:1

*Line recovery in inches per handle turn

Features and Operations Instructions

Rugged, Lightweight Engineering Composite Frame and Rotor

The frame and rotor were designed to be lightweight and durable. This reduced weight is meaningful when surf casting all day. The engineering plastic composite will not corrode.

Double-Shielded Stainless Steel Ball Bearings

Each Breakwater spinning reel contains double-shielded stainless steel ball bearings. These bearings are made from stainless steel to prevent corrosion and are designed to keep debris from getting inside them.

Cyclone Spool

The spool used on the Breakwater surf reel is forged for strength and anodized to prevent corrosion. It is also elongated and tapered. This design encourages long casts and even line lay during the retrieve.

Teflon® Drag System

Your Offshore Angler reel comes equipped with a drag stack that is made of stainless steel and Teflon washers. These materials were chosen because they are durable and dissipate heat extremely well. The combination of these materials also provides a powerful max drag that is critical when the fight is on!

Powerlock™ Instant Anti-Reverse

Our Powerlock instant anti-reverse is a special type of bearing that allows the handle to only turn forward. There is no backplay in the handle. This allows for positive hooksets.

Machined-Cut Aluminum Handle

This reel's handle is machine cut from aluminum bar stock and anodized to prevent corrosion. This provides leverage you can count on when landing a trophy. The egg-shaped handle knob is affixed to the handle with a stainless steel rivet.

Foulproof Rotor

Many surf reels experience a problem related to the line getting caught underneath the spool during a cast. Our rotor was designed to solve this problem. Attached to the spool is a spool skirt guard. It prevents line from getting trapped under the spool.

Oversized Line Roller

Line twist is a common problem with spinning reels. This reel is equipped with an oversized, titanium-nitride-coated stainless steel ball bearing line roller that helps prevent line twist during the retrieve.

Fishing Reel Tips and Maintenance

Tips

The following suggestions will help you to get peak performance from your new reel. One challenge of using a spinning reel is dealing with line twist. The spool position is fixed on a spinning reel, and the line is wrapped onto the spool at a right angle via the rotating bail. This can lead to line twist, the tendency of line to bunch together or form loops. Line twist is the most common cause of spinning reel tangles. In order to minimize line twist when fighting a fish, do not reel against the drag. Reeling against the drag does not bring the fish any closer to you. When line is being pulled off the reel, allow the drag to do its job. Once the fish stops running, pull the fish toward you by raising the rod tip and reeling up the gained line. ALWAYS keep tension on your line! If your line does become twisted, cut off your hook and/or rig and allow the line to relax in the current or behind a slow moving boat. This will allow the twist to uncoil, improve performance, and extend the life of your line.

Keep your reel fully spooled. This maximizes casting distance and the amount of line gained per turn of the handle.

At the end of each trip, always cut off approximately 10'-15' from the working end of your line to ensure that your line does not have any nicks or abrasions for your next outing.

Maintenance

Your new reel is designed to provide years of dependable service. But, like any other precision machine, periodic cleaning and maintenance is required for continued peak performance.

After each use, wash your reel with a gentle, warm (if possible) freshwater spray to remove salt deposits. Do not use a forceful spray as this can force salt and sand particles into the reel. After thoroughly washing the reel, dry any excess water with a soft cloth.

Reels today require lightweight grease and oil to be applied regularly. The more often you fish, the more frequently these lubricants should be applied. Oil and grease should be used sparingly; too much can have a negative impact on reel performance. There are lightweight oils and greases made specifically for fishing reels that can be found at basspro.com/cabelas.com

As a rule of thumb, oils should be used to lubricate any moving part on the reel (ball bearings, bushings, handle joints, ball springs, etc.). Grease should be used to lubricate the main drive gear and pinion gear.

We do not recommend using any multipurpose oils. Many of these oils have properties that will attract dirt and dust to the internal parts. This may cause excessive wear and reduce the life of the reel.

We recommend lubricating the following areas with a reel oil:

Handle knob



Handle post



Bail arm and line roller



Bail cam



Body sidecover bearings



Store the reel in a cool, dry area - avoid moist, enclosed areas like a rod locker. **DO NOT STORE YOUR REEL IN A PLASTIC BAG!**

Be sure to loosen your drag knob to allow the drag stack to relax when not in use. This will prevent your drag from sticking and will prolong the life of the drag.

Periodically check your reel for loose screws. Tighten as necessary.

For professional cleaning and maintenance, send your reels postage prepaid to:

Outdoor World Rod & Reel Repair
 2300 E. Turner, Suite M
 Springfield, MO 65803
 Phone: (417) 873-5274 Fax: (417) 873-5280

Bass Pro Shops®/Cabela's Fishing Reels Limited Warranty

Bass Pro Shops and Cabela's will repair or replace (at our discretion) any Offshore Angler™ reel which proves to be defective in workmanship or materials within 1 year from the original date of purchase. You must save your dated sales receipt for warranty validation. This warranty gives you specific legal rights, and you may have other rights which vary from state to state or province to province.

For reels purchased through our catalogs or Bass Pro Shops/Cabela's online:

- **For reel replacement only:** Return your reel postage prepaid with your dated sales receipt to the Return Center address listed on your receipt.
- **For reel repair only:** Return your reel postage prepaid with a copy of your dated sales receipt as proof of purchase and warranty validation to the Outdoor World Rod & Reel Repair® address below.

For reels purchased through Bass Pro Shops/Cabela's retail locations:

- **For reel replacement only:** Return your reel (postage prepaid if sending by mail) along with your dated sales receipt to the store from which it was purchased.
- **For reel repair only:** Return your reel postage prepaid with a copy of your dated sales receipt as proof of purchase and warranty validation to the Outdoor World Rod & Reel Repair address below.

Outdoor World Rod & Reel Repair
 2300 E. Turner, Suite M
 Springfield, MO 65803

This warranty does not cover lost parts, malfunctions, or damage due to abuse, accidents, or normal wear. Failure to clean, lubricate, and provide reasonable and necessary maintenance will void the warranty. Repairs needed to your reel due to abnormal use or modification, or after warranty expiration, are available for a reasonable charge from Outdoor World Rod & Reel Repair, providing the reel is returned postage paid.

Except to the extent prohibited by applicable law, there are no warranties or conditions, express or implied, other than those expressly set out herein. Bass Pro Shops/Cabela's shall not, under any circumstances, be liable for an amount greater than the actual purchase price of the product nor for any special, incidental, or consequential damages suffered or incurred in connection with the product and Bass Pro Shops/Cabela's does not assume, and does not authorize any person to assume for it, any obligation or liability other than those expressly set out herein.

Made in China. basspro.com/cabelas.com

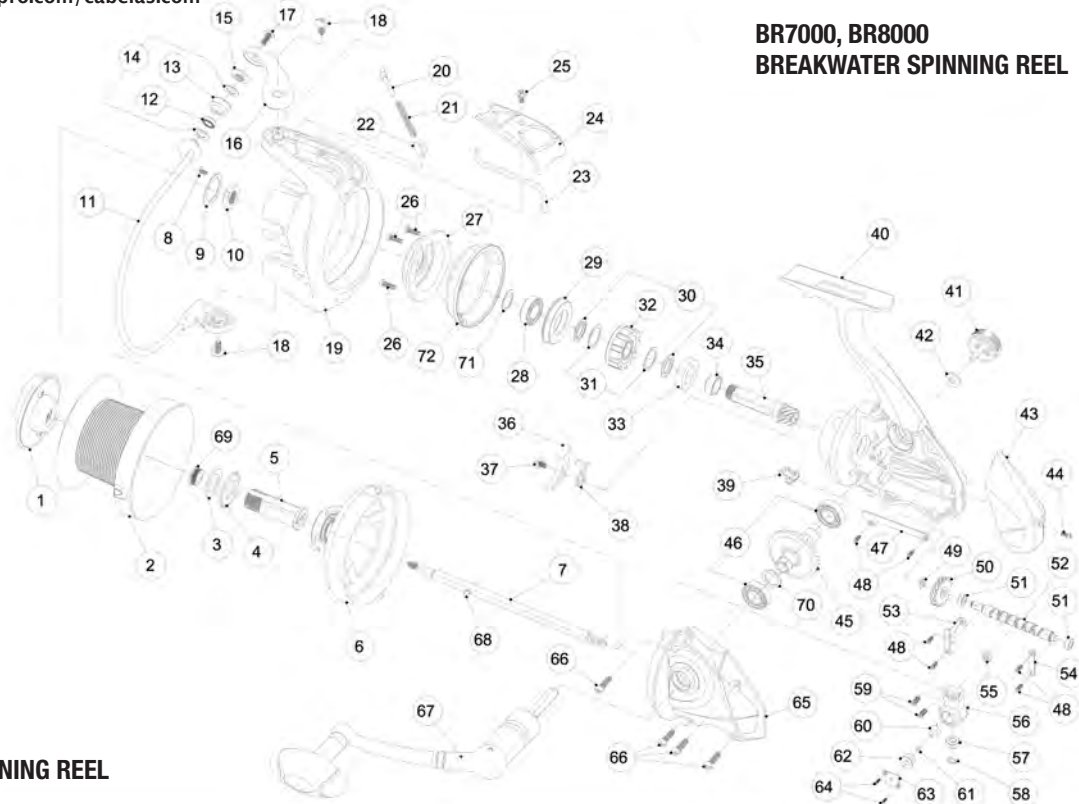

**BR7000, BR8000
 BREAKWATER SPINNING REEL**

**BR7000, BR8000
 BREAKWATER SPINNING REEL
 NO. PART NAME**

1	DRAG-KNOB ASSEMBLY	17	SCREW	33	BUSHING	49	LOCK WASHER	65	COVER PLATE
2	SPOOL ASSEMBLY	18	SCREW	34	PINION SPACER	50	WORM-SHAFT GEAR	66	SCREW
3	MAIN-SHAFT WASHER	19	PICK UP HOUSING	35	PINION	51	BUSHING	67	CRANK ASSEMBLY
4	CLICK RATCHET	20	TRIP PISTON	36	N-R PAWL	52	WORM SHAFT	68	MAIN-SHAFT PIN
5	SPOOL STEM	21	TRIP SPRING	37	SCREW	53	WORM-SHAFT FRONT RETAINER	69	SPOOL-STEM NUT
6	LINE-GUARD ASSEMBLY	22	TRIP-SPRING HOLDER	38	N-R SPRING	54	WORM-SHAFT REAR RETAINER	70	DRIVE-GEAR WASHER
7	MAIN SHAFT	23	TRIP PLUNGER	39	N-R LEVEL PLUG	55	BUSHING	71	WASHER
8	SCREW	24	BAIL-ARM COVER	40	FRAME	56	LEVEL-WIND BRACKET	72	BEARING-RETAINER COVER
9	WASHER	25	SCREW	41	HANDLE SCREW	57	BUSHING		
10	PICK UP HOUSING NUT	26	SCREW (X3)	42	HANDLE WASHER	58	LOCK WASHER		
11	BAIL-WIRE ASSEMBLY	27	BALL-BEARING RETAINER	43	REAR COVER	59	SCREW		
12	BALL BEARING	28	BALL BEARING	44	SCREW	60	SCREW HOLDER		
13	NON-TWIST LINE ROLLER	29	BEARING OUTER	45	DRIVE GEAR	61	HOLDER WASHER		
14	WASHER (X2)	30	SPACER (X2)	46	BALL BEARING	62	HOLDER SLEEVE		
15	LINE-ROLLER WASHER	31	WASHER (X2)	47	LEVEL-WIND BRACKET RETAINER	63	MAIN-SHAFT HOLDER		
16	BAIL BRACKET	32	ONE-WAY CLUTCH ASSEMBLY	48	SCREW	64	SCREW		